

433 Lakeside Avenue Marlborough, MA

For Lease



Building:
6,724 Sq. Ft.
Retail space
available for lease:
3,362-1,640 Sq. Ft.

Lakeside Avenue is a well developed, highly traveled economic corridor, which hosts several national branded hotels and supports a significant amount of retail trade within the surrounding area. There is an estimated 4 million SF of office and R&D space within 3 miles. Area tenants include Hannaford, Supermarket, Office Max, Sleepy's, Planet Fitness, Longhorn Steakhouse, Five Guys, Starbucks, Panera Bread, Wendy's, Ninety Nine and much more.

Contact Exclusive Agent:

Bret O'Brien

bret@greaterbostoncp.com • 508-925-7477

Tyler DeWolfe

tyler@greaterbostoncp.com • 508-709-0377

Legal Disclaimer: Every effort has been made to furnish the most accurate information available on this property. However, all statements and conditions contained herein are subject to errors, omissions, prior sale or removal from the market without notice.

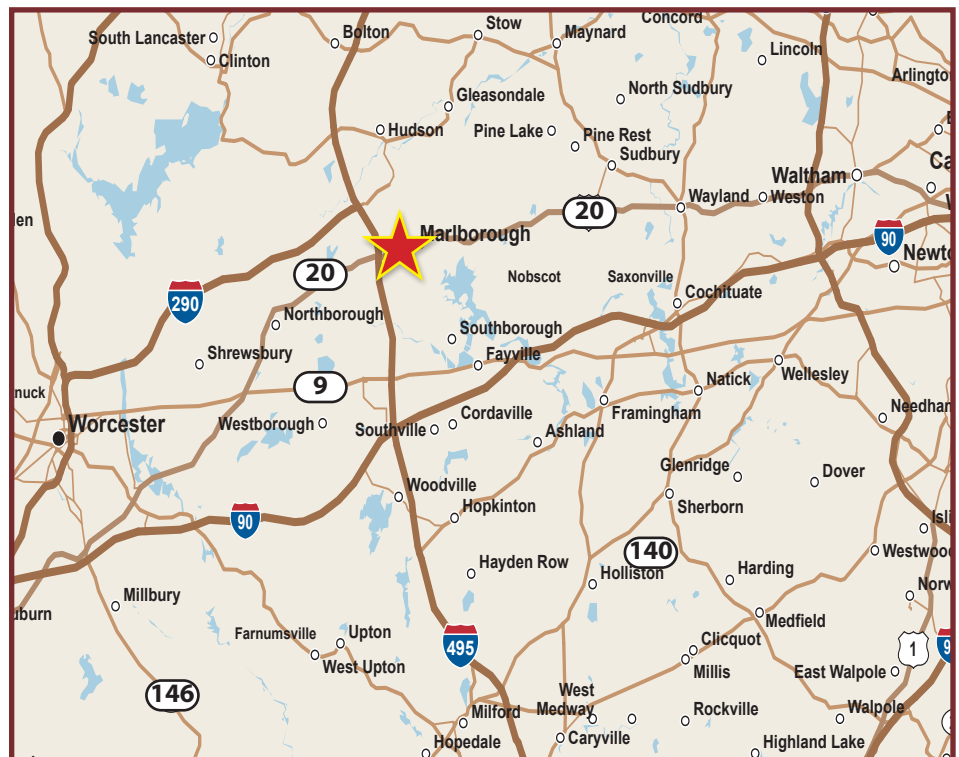

www.greaterbostoncp.com

GREATER BOSTON COMMERCIAL PROPERTIES INC.

44 Bearfoot Road, Suite 125, Northborough, MA 01532

433 Lakeside Avenue Marlborough, MA

For Lease

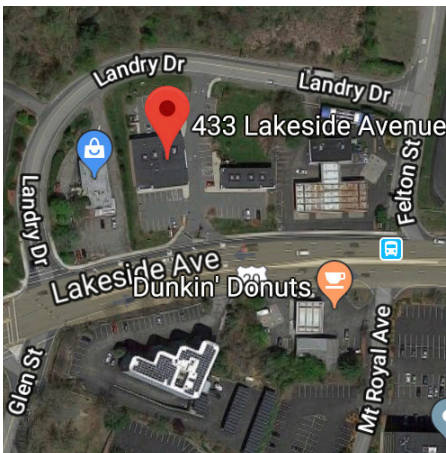

Contact Exclusive Agent:

Bret O'Brien

bret@greaterbostoncp.com • 508-925-7477

Tyler DeWolfe

tyler@greaterbostoncp.com • 508-709-0377

Legal Disclaimer: Every effort has been made to furnish the most accurate information available on this property. However, all statements and conditions contained herein are subject to errors, omissions, prior sale or removal from the market without notice.

www.greaterbostoncp.com

GREATER BOSTON COMMERCIAL PROPERTIES INC.

44 Bearfoot Road, Suite 125, Northborough, MA 01532

433 Lakeside Avenue Marlborough, MA

For Lease

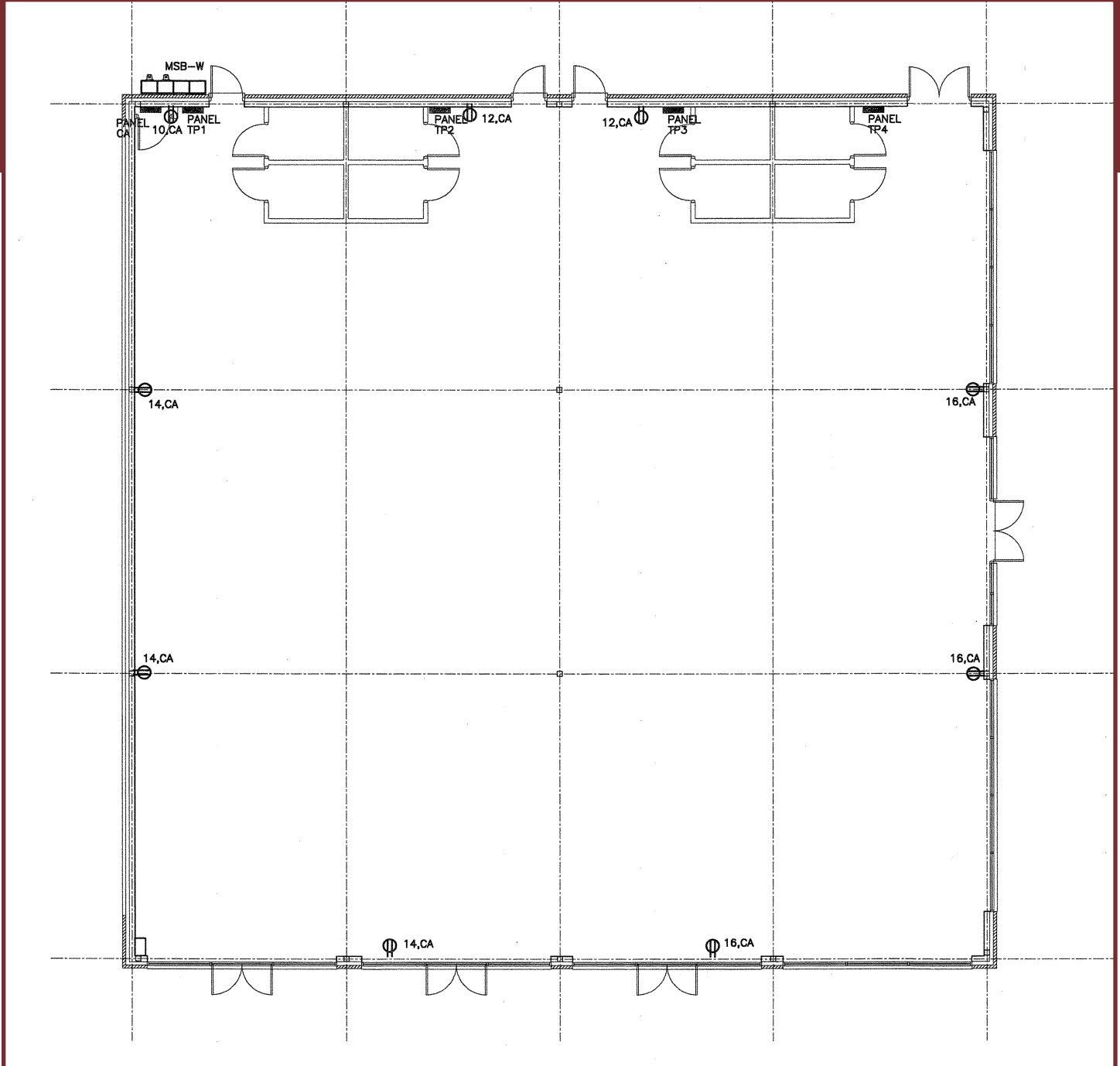

Contact Exclusive Agent:

Bret O'Brien

bret@greaterbostoncp.com • 508-925-7477

Tyler DeWolfe

tyler@greaterbostoncp.com • 508-709-0377

Legal Disclaimer: Every effort has been made to furnish the most accurate information available on this property. However, all statements and conditions contained herein are subject to errors, omissions, prior sale or removal from the market without notice.

www.greaterbostoncp.com

GREATER BOSTON COMMERCIAL PROPERTIES INC.

44 Bearfoot Road, Suite 125, Northborough, MA 01532

433 Lakeside Avenue Marlborough, MA

For Lease



Contact Exclusive Agent:

Bret O'Brien

bret@greaterbostoncp.com • 508-925-7477

Tyler DeWolfe

tyler@greaterbostoncp.com • 508-709-0377

Legal Disclaimer: Every effort has been made to furnish the most accurate information available on this property. However, all statements and conditions contained herein are subject to errors, omissions, prior sale or removal from the market without notice.

www.greaterbostoncp.com

GREATER BOSTON COMMERCIAL PROPERTIES INC.

44 Bearfoot Road, Suite 125, Northborough, MA 01532