

# 108 Milk Street Westborough, MA

For Sale

## 19,200 Sq. Ft. Flex Property



- First floor Industrial bays
- Second floor Retail Suites
- Located Directly off Rt. 135
- Half Mile from Rt. 9 and Westborough Rotary
- 2.34 Acre Lot
- 1,200 Sq. Ft. covered parking area

Contact Exclusive Agent:

**Tyler DeWolfe** Vice President  
tyler@greaterbostoncp.com • 508-277-5664

**Benjamin Gatti** Executive Vice President  
ben@greaterbostoncp.com • 508-273-2133

Legal Disclaimer: Every effort has been made to furnish the most accurate information available on this property. However, all statements and conditions contained herein are subject to errors, omissions, prior sale or removal from the market without notice.

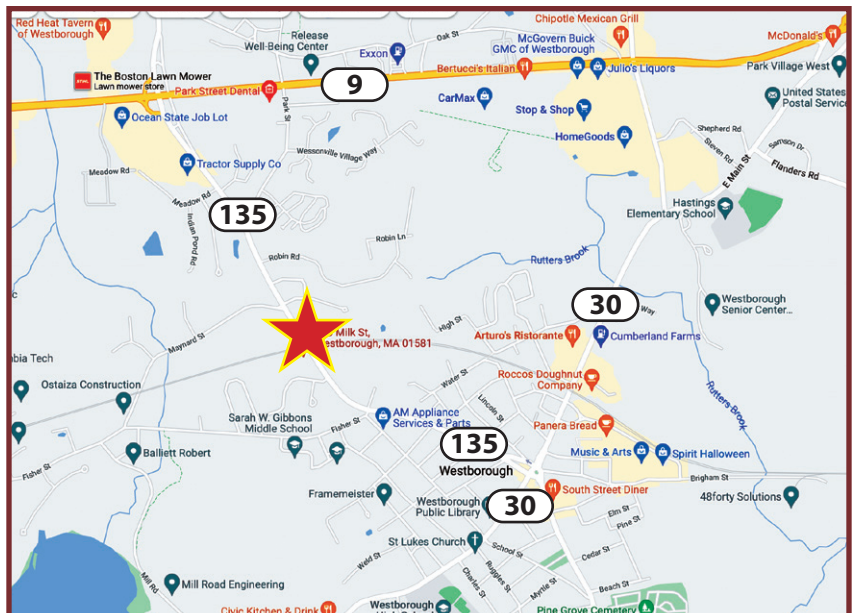

[www.greaterbostoncp.com](http://www.greaterbostoncp.com)

## GREATER BOSTON COMMERCIAL PROPERTIES INC.

44 Bearfoot Road, Suite 375, Northborough, MA 01532

# 108 Milk Street Westborough, MA

For Sale



**Contact Exclusive Agent:**

**Tyler DeWolfe** *Vice President*  
tyler@greaterbostoncp.com • 508-277-5664

**Benjamin Gatti** *Executive Vice President*  
ben@greaterbostoncp.com • 508-273-2133

**Legal Disclaimer:** Every effort has been made to furnish the most accurate information available on this property. However, all statements and conditions contained herein are subject to errors, omissions, prior sale or removal from the market without notice.

[www.greaterbostoncp.com](http://www.greaterbostoncp.com)

**GREATER BOSTON  
COMMERCIAL PROPERTIES INC.**

44 Bearfoot Road, Suite 375, Northborough, MA 01532